



# Technical Datasheet

## 3M™ Aura™ 9400+ Series Particulate Respirators

### Description

The 3M™ Aura™ 9400+ Series Particulate Respirators provide effective respiratory protection for use in environments where workers will be exposed to airborne dust particles and non-volatile liquid particles.

- Tested and CE Approved to EN 149:2001+A1:2009
- Foldable, easy to store, proprietary 3-panel design accommodates facial movement for wearer comfort
- Made without staples or small detachable parts.
- Nose clip is kept securely in place within the layers of the respirator.
- Distinguishable non-food colour (bright blue) to ensure quick search recognition
- Metal detectable due to the embedded metal nose clip
- 3M low breathing resistance filter technology gives effective filtration with low breathing resistance for consistent high quality performance
- Sculpted nose panel helps conforms to the nose and contours of the face and helps to improve compatibility with 3M eyewear
- Innovative chin tab designed for ease of donning and adjustment to help achieve a comfortable fit
- 3M™ Cool Flow™ exhalation valve offers improved comfort in hot humid environments and/or where work is hard and physical
- Large, soft nosefoam is comfortable on the skin
- Individual hygienic packaging helps protect the respirator from contamination before use
- Even strap pressure improves comfort on the neck, face and head with a secure feel
- Coloured headbands for easy identification: blue for FFP2, red for FFP3

### Materials

The following materials are used in the production of the 3M™ Aura™ 9400+ series respirators:

• Straps	Thermoplastic Elastomer
• Nose Foam	Polyurethane
• Nose Clip	Aluminium
• Filter	Polypropylene
• Valve	Polypropylene
• Valve diaphragm	Polyisoprene

**These products do not contain components made from natural rubber latex.**

Maximum mass of products: 18g

### Standards

These products meet the requirements of European Standard EN 149:2001 + A1:2009, filtering facepiece respirators for use against particles. It should be used to protect the wearer from solid and non-volatile liquid particles only.

Performance tests in this standard include filter penetration; extended exposure (loading) test; flammability; breathing resistance and total inward leakage. A full copy of EN 149:2001+A1:2009 can be purchased from your national standards body.

Designations:

NR = Non reusable (single shift use only)

D = Meets the clogging resistance requirements

### Approvals

These products meet the requirements of the European Community Directive 89/686/EEC (Personal Protective Equipment Directive) and are thus CE marked.

Certification under Article 10, EC Type-Examination and Article 11, EC quality control, has been issued for these products by BSI Product Services, Maylands Avenue, Hemel Hempstead, HP2 4SQ, UK (Notified Body number 0086).

### Applications

These respirators are suitable for use in concentrations of solid and non-volatile liquid particles up to the following limits:

Model	EN 149+A1 Classification	Exhalation Valve	Maximum use concentration
9422+	FFP2 NR D	Valved	10 x WEL*
9432+	FFP3 NR D	Valved	20 x WEL*

\*WEL = Workplace Exposure Limit

**Respiratory protection is only effective if it is correctly selected, fitted and worn throughout the time when the wearer is exposed to hazards.**

### Storage and Transportation

The 3M™ Aura™ 9400+ Series Particulate Respirator have a shelf life of 5 years. End of shelf life is marked on the product packaging. Before initial use, always check that the product is within the stated shelf life (use by date). Product should be stored in clean, dry conditions within the temperature range: – 20°C to + 25°C with a maximum relative humidity of <80%. When storing or transporting this product use original packaging provided.

### Disposal

Used products should be disposed of in accordance with national regulations.



Distributed by Industrial Scientific Supplies, a division of Camlab Ltd

Camlab Ltd, Norman Way Industrial Estate, Over, Cambridge, CB24 5WE

Telephone: +44 (0)1954 233145

Email: sales@camlab.co.uk

www.industrialscientific.co.uk



## Fitting Instructions

See Figure 1.

Before fitting device, ensure hands are clean.

1. and 2. Pre-stretch around entire length of each strap by pulling at 3cm intervals between both hands.
3. With reverse side up and using tab, separate top and bottom panels to form a cup shape. Bend slightly at the centre of the noseclip.
4. Ensure both panels are fully unfolded.
5. Cup respirator in one hand with open side towards face. Take both straps in other hand. Hold respirator under chin, with nosepiece up, and pull straps over head.
6. Locate the upper strap across the crown of the head and the lower strap below the ears. Straps must not be twisted. Adjust top and bottom panels for a comfortable fit, ensuring panels and tab are not folded in.
7. Using both hands, mould noseclip to the shape of the nose to ensure a close fit and good seal. Pinching the noseclip using only one hand may result in less effective respirator performance.
8. The seal of the respirator on the face should be fit-checked before entering the workplace.

Figure 1

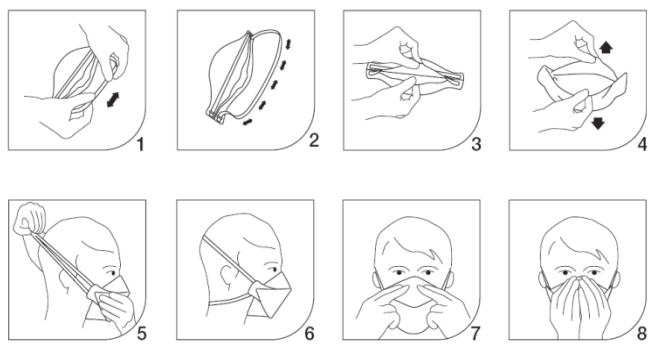

## Fit Check

1. Cover the front of the respirator with both hands being careful not to disturb the fit of the respirator.
2. VALVED respirator - INHALE sharply;
3. If air leaks around the nose, re-adjust the noseclip to eliminate leakage. Repeat the above fit check.
4. If air leaks at the respirator edges, work the straps back along the sides of the head to eliminate leakage. Repeat the above fit check.

**If you CANNOT achieve a proper fit DO NOT enter the hazardous area.** See your supervisor.

Users should be fit tested in accordance with national requirements. For information regarding fit testing procedures, please contact 3M.

## ⚠ Warnings and Use Limitations

- Always be sure that the complete product is:
    - Suitable for the application;
    - Fitted correctly;
    - Worn during all periods of exposure;
    - Replaced when necessary.
  - Proper selection, training, use and appropriate maintenance are essential in order for the product to help protect the wearer from certain airborne contaminants.
  - Failure to follow all instructions on the use of these respiratory protection products and/or failure to properly wear the complete product during all periods of exposure may adversely affect the wearer's health, lead to severe or life threatening illness or permanent disability.
  - For suitability and proper use follow local regulations and refer to all information supplied. For more information contact a safety professional/3M representative.
  - Before use, the wearer must be trained in use of the complete product in accordance with applicable Health and Safety standards/guidance.
  - These products do not protect against gases/vapours.
  - Do not use in atmospheres containing less than 19.5% oxygen. (3M definition. Individual countries may apply their own limits on oxygen deficiency. Seek advice if in doubt).
  - Do not use for respiratory protection against atmospheric contaminants/concentrations which are unknown or immediately dangerous to life and health (IDLH).
  - **Do not use with beards or other facial hair that may inhibit contact between the face and the product thus preventing a good seal.**
  - Leave the contaminated area immediately if:
    - a) Breathing becomes difficult.
    - b) Dizziness or other distress occurs.
  - Discard and replace the respirator if breathing resistance becomes excessive or at the end of a shift.
  - Never alter, modify or repair this device.
- In case of intended use in explosive atmospheres, contact 3M.

## 3M Health & Safety Helpline

0870 60 800 60 (UK) 1 800 320 500 (Ireland)



## 3M Safety Solutions

**3M United Kingdom**  
3M Centre  
Cain Road, Bracknell  
Berkshire RG12 8HT  
Tel: 0870 60 800 60  
[www.3M.co.uk/ohes](http://www.3M.co.uk/ohes)

**3M Ireland Limited**  
The Iveagh Building  
The Park, Carrickmines  
Dublin 18  
Tel: 1 800 320 500



**Distributed by Industrial Scientific Supplies, a division of Camlab Ltd**

Camlab Ltd, Norman Way Industrial Estate, Over, Cambridge, CB24 5WE  
Telephone: +44 (0)1954 233145  
Email: [sales@camlab.co.uk](mailto:sales@camlab.co.uk)  
[www.industrialscientific.co.uk](http://www.industrialscientific.co.uk)