



3M™ Welding Respirators

Fitting Instructions



3M Welding Respirators

Respirator	Type	APF
9925	FFP2	10
9928	FFP2	10

Standard: EN149:2001

This respirator should not be used in oxygen deficient environments, for escape purposes or by people with beards/ facial hair or in atmospheres where concentrations of contaminant may exceed that deemed Immediately Dangerous to Life and Health (IDLH).

Clever thinking at work

3M Health & Safety Helpline
Monday - Friday 9 to 5

0870 60 800 60 UK
1 800 320 500 IRELAND

Occupational Health & Environmental Safety Group

3M United Kingdom plc
3M Centre,
Cain Road, Bracknell
Berkshire RG12 8HT
Tel: 0870 60 800 60
www.3M.co.uk/ohes

3M Ireland Limited
The Iveagh Building
The Park
Carrickmines
Dublin 18
Tel: 1 800 320 500

ACCREDITED
RPE Fit Test
Provider

Please recycle. Printed in UK.
© 3M 2009. All rights reserved.

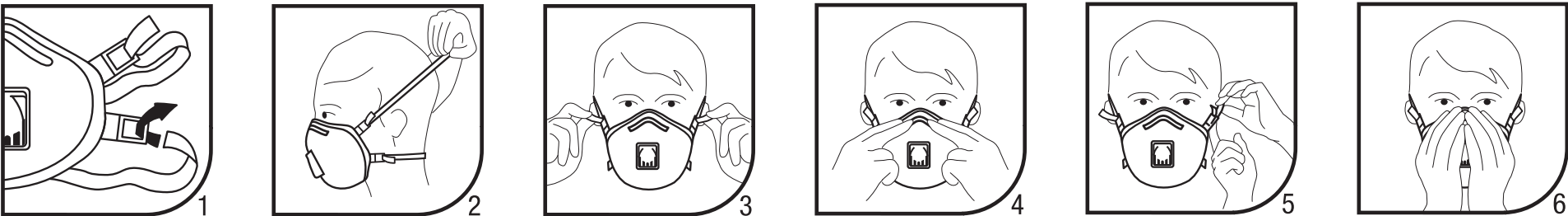

1. Thread top elastic strap through top buckles. Repeat for bottom strap and buckles. Place the bottom elastic strap around the head just below the ears. Untwist the strap.
2. Place the top elastic strap around the head, above the ears. Untwist the strap.
3. Adjust tension by pulling tabs of each strap, as shown.
4. Using both hands, mould metal nosepiece comfortably to shape of nose. Pinching the nosepiece using one hand may result in less effective respirator performance.
5. Strap tension may be decreased without removing respirator from the head by pushing out on the back of the buckles.
6. The seal of respirator on the face should be fit checked prior to wearing in the work area.

Fit Check Procedure

- a) Cover the front of the respirator with both hands, being careful not to disturb the position of respirator.
- b) Inhale sharply. A negative pressure should be felt inside respirator. If any air leaks around the nose, readjust the nosepiece as described in step 4. If air leaks at the respirator edges adjust the position of the respirator and/ or tension of the straps. Retest the seal. Repeat the procedure until the respirator is sealed properly.

If you cannot achieve a proper fit do not enter contaminated area. See your supervisor.

Note: Do not use with beards or other facial hair that may inhibit contact between the face and the edge of the respirator.

www.camlab.co.uk

INDUSTRIAL SCIENTIFIC SUPPLIES

Distributed by Industrial Scientific Supplies, a division of Camlab Ltd

Camlab Ltd, Norman Way Industrial Estate, Over, Cambridge, CB24 5WE
Telephone: +44 (0)1954 233145
Email: sales@camlab.co.uk
www.industrialscientific.co.uk